

BUILDINGS FOR GENERAL BREWING CORPORATION, SAN FRANCISCO
Frederick H. Meyer, Architect

A BREWERY and TWO BRANCH LIBRARIES

THE photograph on the opposite page illustrates one of two brew kettles, recently installed in the new plant of the General Brewing Corporation in San Francisco. Weighing 90,000 pounds in operation this huge copper container holds enough beer to fill approximately 100,000 bottles or 285 barrels. The brewing process takes some two and one half hours when the kettle is emptied and refilled.

Special structural steel bracing was necessary because of the weight of the two kettles. Providing for such an installation is just an-

other example of the wide scope of an architect's practice.

It may seem a far cry from a \$1,500,000 brewery to a \$50,000 public library building, but that again emphasizes the architect's diversified field. The two branch library buildings illustrated are charming in their simple California style of treatment. Plan, general arrangement and detail are not dissimilar to the Anza Street branch library in San Francisco, designed by John Reid, Jr., and which has proved so satisfactory to both city officials and patrons. The two buildings are constructed of reinforced concrete with hardwood interior finish and asphaltic tile floors.

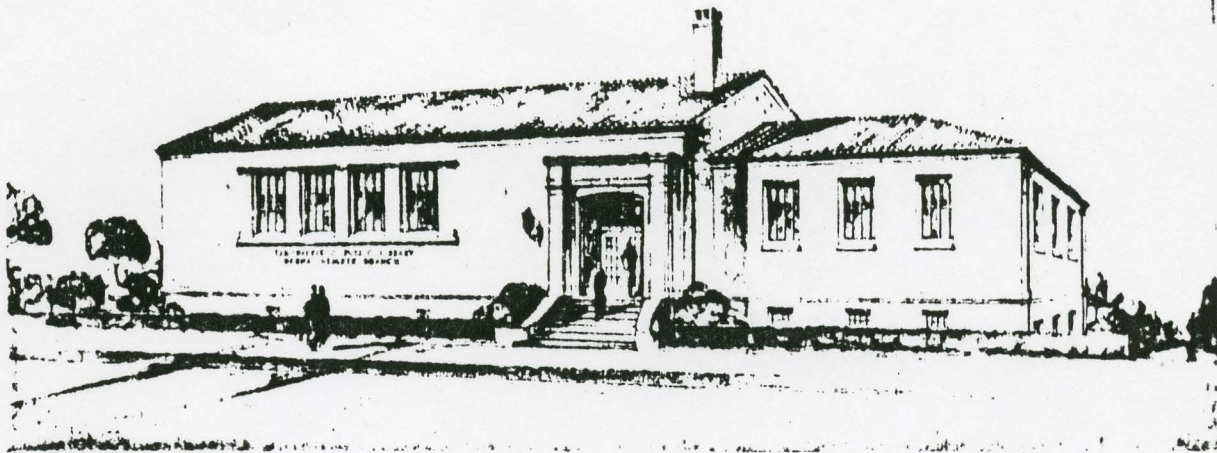

BERNAL HEIGHTS BRANCH LIBRARY, SAN FRANCISCO
Frederick H. Meyer, Architect

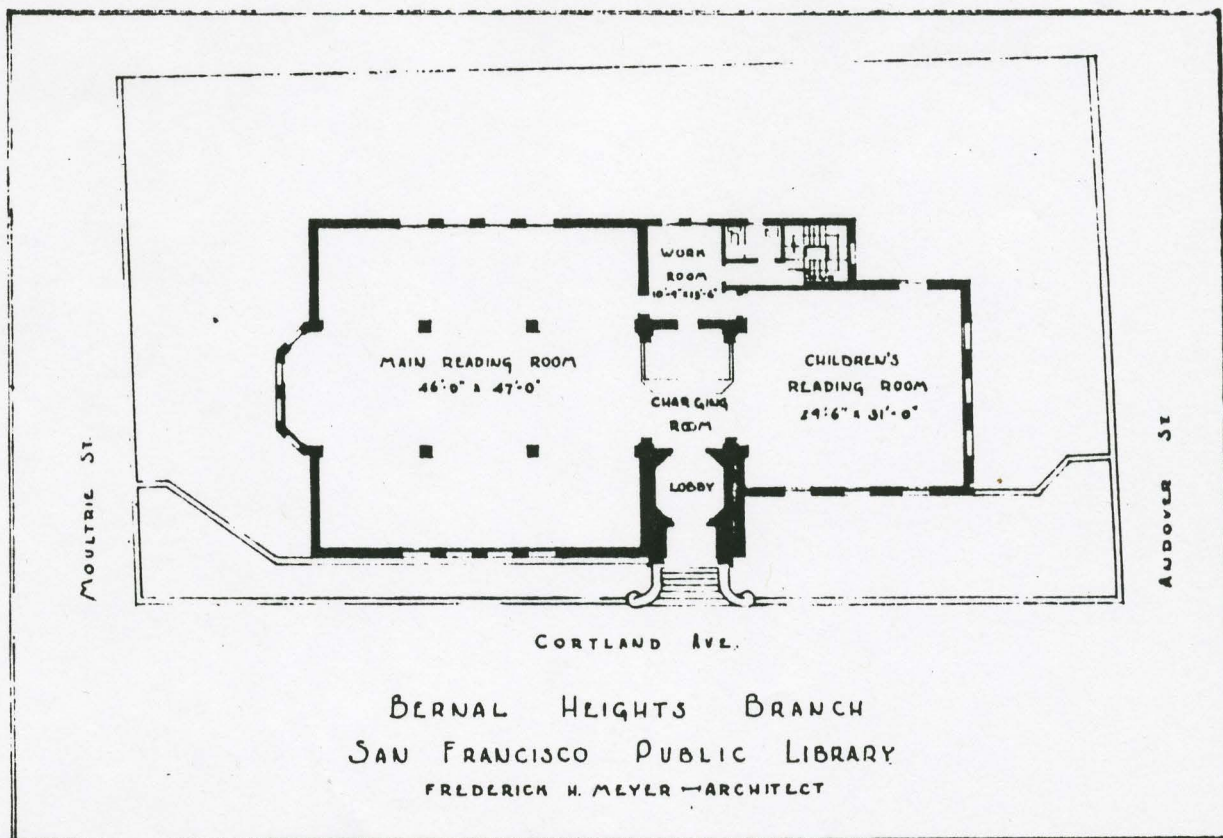



WEST PORTAL BRANCH LIBRARY, SAN FRANCISCO, CALIFORNIA
Frederick H. Meyer, Architect

